

NOTES

1. MATERIALS:  
HOUSING-PBT 30%GF UL94V-0.  
CONTACT-PHOSPHOR BRONZE, C5191R-H T=0.6mm
2. FLASH: 0.25mm MAX.
3. CAMBER: 0.13mm MAX. DEFOMATION: NA.  
WARP: 0.13mm MAX TWIST: NA.
4. COLOR: BLACK
5. PLATING:  
TIN 100u" MIN OVER Ni 50u" MIN.  
Ni 80u" MIN.

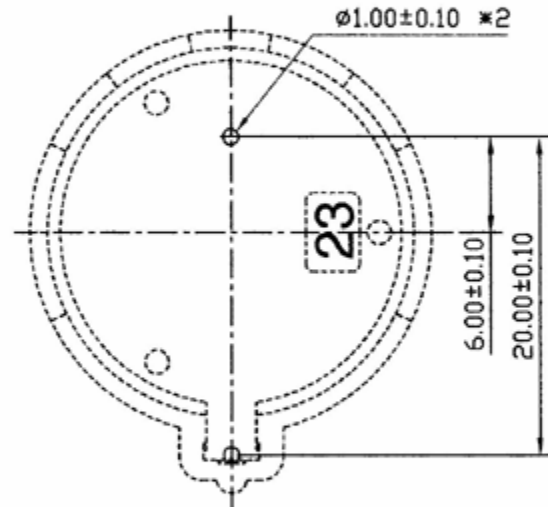

RECOMMEND PCB LAYOUT  
COMPONENT SIDE

3		MICROPOWER BATTERY CO.			
2					
1		NAME	BH-2325-CH25		
NO.	DATE	SCALE	2 : 1	APPD.	<i>J. K. Lin</i>
		UNIT	MM	CHKD.	<i>Huan/Ting/Lian</i>
		MAT'L		DWN.	
		DATE	04/12/02	DR NO.	BH-2325

General Tolerances:  
 Angel: +/-2°  
 Dim: 0.0 +/- 0.25  
 0.00 +/- 0.20  
 0.000 +/- 0.10